

Vehicle Details



Stock #AV270003**VIN**1GCPYCEL5MZ420592**Year**2021**Stock Type**Used**Make**Chevrolet**Model**Silverado 1500**Style**4WD Crew Cab 147" Custom Trail Boss**Exterior Color**Cherry Red Tintcoat**Published Price**\$40,088.00

Disclaimer

Sales Tax, Title Fee, License & Registration Fees, Dealer Documentary Fee, Finance Charges, Emission Testing Fees and / or Compliances Fees are in addition to the advertised price. Prices and special offers are subject to change. Mileage listings are estimates and are not necessarily accurate odometer readings.

Photos



Features

Standard Equipment

ENTERTAINMENT

- 4G LTE Wi-Fi Hotspot capable (Terms and limitations apply. See onstar.com or dealer for details.)
- Audio system feature, 6-speaker system
- Audio system, Chevrolet Infotainment 3 system 7" diagonal color touchscreen, AM/FM stereo. Additional features for compatible phones include: Bluetooth audio streaming for 2 active devices, voice command pass-through to phone, wired Apple CarPlay and Android Auto capable.
- Bluetooth for phone, connectivity to vehicle infotainment system

AutoDiary

Used 2021 Chevrolet Silverado 1500 4WD Crew Cab 147" Custom Trail Boss (#AV270003)

Features (continued)

ENTERTAINMENT

- SiriusXM Radio enjoy an All Access trial subscription with over 150 channels including commercial-free music, plus sports, news and entertainment. Plus listening on the SiriusXM app, online and at home on compatible connected devices is included, so you'll hear the best SiriusXM has to offer, anywhere life takes you. Welcome to the world of SiriusXM. (IMPORTANT: The SiriusXM radio trial package is not provided on vehicles that are ordered for Fleet Daily Rental ("FDR") use. If you decide to continue service after your trial, the subscription plan you choose will automatically renew thereafter

EXTERIOR

- Bumper, front (High gloss black.)
- Bumper, rear (High gloss black.)
- Cargo tie downs (12), fixed rated at 500 lbs per corner
- CornerStep, rear bumper
- Door handles, Black
- GLASS, DEEP-TINTED
- Grille (High gloss Black bars with mesh inserts.)
- Headlamps, halogen reflector with halogen Daytime Running Lamps
- Lamps, cargo area, cab mounted integrated with center high mount stop lamp, with switch in bank on left side of steering wheel
- LED Cargo Area Lighting located in pickup bed, activated with switch on center switch bank or key fob
- MIRRORS, OUTSIDE HEATED POWER-ADJUSTABLE
- Recovery hooks, performance Red
- Tailgate and bed rail protection cap, top
- Tailgate, gate function manual with EZ Lift includes power lock and release
- TAILGATE, STANDARD
- Taillamps, LED with signature
- Tire carrier lock, keyed cylinder lock that utilizes same key as ignition and door
- TIRE, SPARE 265/70R17SL ALL-SEASON, BLACKWALL
- TIRES, LT275/65R18C MT BLACKWALL GOODYEAR WRANGLER DURATRAC
- WHEEL, 17" X 8" (43.2 CM X 20.3 CM) FULL-SIZE, STEEL SPARE
- WHEELS, 18" X 8.5" (45.7 CM X 21.6 CM) HIGH GLOSS BLACK PAINTED ALUMINUM

AutoDiary

Used 2021 Chevrolet Silverado 1500 4WD Crew Cab 147" Custom Trail Boss (#AV270003)

Features (continued)

INTERIOR

- Air conditioning, single-zone
- Air vents, rear, heating/cooling
- Assist handles front A-pillar mounted for driver and passenger, rear B-pillar mounted
- Chevrolet Connected Access capable (Subject to terms. See onstar.com or dealer for details.)
- Compass located in instrument cluster
- Cruise control, electronic with set and resume speed, steering wheel-mounted
- Defogger, rear-window electric
- DOOR LOCKS, POWER
- Driver Information Center, 3.5" diagonal monochromatic display
- Exterior Temperature Display located in radio display
- FLOOR COVERING, COLOR-KEYED CARPETING
- Floor mats, rubberized vinyl, front (Deleted when LPO floor liners are ordered.)
- Floor mats, rubberized-vinyl rear (Deleted when LPO floor liners are ordered.)
- Instrument cluster, 6-gauge cluster featuring speedometer, fuel level, engine temperature, tachometer, voltage and oil pressure
- Mirror, inside rearview, manual tilt
- Power outlet, front auxiliary, 12-volt
- Rear seat reminder
- REMOTE KEYLESS ENTRY, WITH 2 TRANSMITTERS
- REMOTE VEHICLE STARTER SYSTEM
- Seat adjuster, driver 4-way manual
- Seat adjuster, passenger 4-way manual
- SEAT TRIM, CLOTH
- Seat, rear 60/40 folding bench (folds up), 3-passenger (includes child seat top tether anchor)
- Seats, front 40/20/40 split-bench with covered armrest storage
- Steering column, Tilt-Wheel, manual with wheel locking security feature
- Steering wheel, urethane
- THEFT-DETERRENT SYSTEM, UNAUTHORIZED ENTRY
- USB PORTS, 2 (FIRST ROW) LOCATED ON INSTRUMENT PANEL
- Window, power front, drivers express up/down
- Window, power front, passenger express down
- Windows, power rear, express down

Features (continued)

MECHANICAL

- Air filter, heavy-duty
- Alternator, 170 amps
- Auto-locking rear differential
- Battery, heavy-duty 730 cold-cranking amps/70 Amp-hr, maintenance-free with rundown protection and retained accessory power (Included and only available with (LV3) 4.3L EcoTec3 V6 engine.)
- Brake lining wear indicator
- Brakes, 4-wheel antilock, 4-wheel disc with DURALIFE rotors
- Capless Fuel Fill
- COOLING, EXTERNAL ENGINE OIL COOLER
- Durabed, pickup bed
- Exhaust, single outlet (Requires (LV3) 4.3L EcoTec3 V6 engine. Includes (VQZ) polished exhaust tip, LPO.)
- Four wheel drive
- Frame, fully-boxed, hydroformed front section
- GVWR, 6900 lbs. (3130 kg) (Crew Cab models require (LV3) 4.3L EcoTec3 V6 engine.)
- Hill descent control
- LPO, Polished exhaust tip (dealer-installed) (Included and only available with (LV3) 4.3L EcoTec3 V6 engine.)
- REAR AXLE, 3.42 RATIO
- SKID PLATES
- Steering, Electric Power Steering (EPS) assist, rack-and-pinion
- Transfer case, two-speed electronic Autotrac with push button control (4WD models only)

OTHER

- Custom Convenience Package includes (BTV) Remote Start with (UTJ) content theft alarm, (C49) rear-window defogger, (UF2) bed LED cargo area lighting and (QT5) EZ Lift power lock and release tailgate
- Infotainment Package includes (U2K) SiriusXM Radio and (UE1) OnStar
- Suspension Package, Z71 Off-Road equipment with 2" lift. Includes (Z7X) Off-Road suspension with 2" lift and monotube shocks, (JHD) Hill Descent Control, (NZZ) skid plates, (K47) heavy-duty air filter and Z71 hard badge
- Trailing Package includes trailer hitch, 7-pin and 4-pin connectors and (CTT) Hitch Guidance

AutoDiary

Used 2021 Chevrolet Silverado 1500 4WD Crew Cab 147" Custom Trail Boss (#AV270003)

Features (continued)

SAFETY

- Airbags, dual-stage frontal airbags for driver and front outboard passenger; Seat-mounted side-impact airbags for driver and front outboard passenger; Head-curtain airbags for front and rear outboard seating positions; Includes front outboard Passenger Sensing System for frontal outboard passenger airbag (Always use seat belts and child restraints. Children are safer when properly secured in a rear seat in the appropriate child restraint. See the Owner's Manual for more information.)
- Daytime running lamps with automatic exterior lamp control
- Hitch Guidance dynamic single line to aid in trailer alignment for hitching
- OnStar and Chevrolet connected services capable (Terms and limitations apply. See onstar.com or dealer for details.)
- REAR VISION CAMERA
- StabiliTrak, stability control system with Proactive Roll Avoidance and traction control, includes electronic trailer sway control and hill start assist
- Teen Driver a configurable feature that lets you activate customizable vehicle settings associated with a key fob, to help encourage safe driving behavior. It can limit certain available vehicle features, and it prevents certain safety systems from being turned off. An in-vehicle report card gives you information on driving habits and helps you to continue to coach your new driver
- Tire Pressure Monitoring System with Tire Fill Alert (does not apply to spare tire)

Optional Equipment

- PINSTRIPE

Technical Specifications

Basic

BASIC	Engine:	ENG,4.3L ECOTEC3 V6
	Cylinders:	8
	Fuel Type:	Gas
	Transmission:	Transmission-Auto
	Transmission Type:	Automatic
	Drive Type:	Four-wheel Drive

AutoDiary

Used 2021 Chevrolet Silverado 1500 4WD Crew Cab 147" Custom Trail Boss (#AV270003)

Technical Specifications (continued)

Chassis Specifications

BRAKES	ABS System:	4-Wheel
	Brake System Type:	Pwr
	Front disc brake (Yes/No):	Yes
	Front disk brake Rotor Diam x Thickness (in):	13.5 x 1.18
	Rear disc brake (Yes/No):	Yes
	Rear disc brake rotor diameter x thickness (in):	13.6 x 0.79
FUEL TANK	Capacity, Approx (gal):	24
	Tank Location:	- TBD -
STEERING	Curb to Curb Turns:	46.3
	Wall to Wall Turns:	N/A
	Ratio (:1), At Lock:	- TBD -
	Ratio (:1), On Center:	- TBD -
	Steering Type:	Electric Rack & Pinion
SUSPENSION	Front Axle Type:	- TBD -
	Front axle Capacity (lb):	- TBD -
	Front Shock Absorber Diameter (mm):	50.0
	Front Spring Capacity (lb):	- TBD -
	Front Spring Type:	Independent
	Rear axle capacity (lb):	- TBD -
	Rear axle type:	- TBD -
	Rear shock absorber diameter (mm):	51.0
	Rear spring capacity (lb):	- TBD -
	Rear Spring Type:	Solid Axle
	Stabilizer Bar Diameter (in):	1.30

Technical Specifications (continued)

Chassis Specifications

TIRES	Front Capacity - each (lb):	- TBD -
	Front Tire Order Code:	R3O
	Front Tire Revolutions/Mile @ 45 mph:	N/A
	Front Tire Size:	LT275/65R18C
	Rear tire capacity (lb):	- TBD -
	Rear tire order code:	R3O
	Rear tire revolutions @ 45 mph:	N/A
	Rear tire size:	LT275/65R18C
	Spare tire capacity (lb):	- TBD -
	Spare tire order code:	XCQ
	Spare tire revolutions @ 45 mph:	N/A
	Spare tire size:	265/70R17SL
WHEELS	Front wheel Size (in):	18 x 8.5
	Front wheel Type:	Aluminum
	Rear wheel size (in):	18 x 8.5
	Rear wheel type:	Aluminum
	Spare wheel size (in):	17 x 8
	Spare wheel type:	Steel

Dimension Specifications

CARGO AREA DIMENSIONS	Cargo Volume (cu ft):	62.9
	Ext'd Cab Cargo Volume (cu ft):	- TBD -
	Height (in):	22.4
	Length @ Floor (in):	69.92
	Tailgate Width (in):	- TBD -
	Width @ Floor (in):	71.4
	Width @ Top, Rear (in):	- TBD -
	Width @ Wheelhousings (in):	50.63

Technical Specifications (continued)

Dimension Specifications

EXTERIOR DIMENSIONS	Cab to Axle (in):	- TBD -
	Cab to End of Frame (in):	- TBD -
	Frame Width, Rear (in):	- TBD -
	Front Bumper to Back of Cab (in):	- TBD -
	Ground Clearance (in), Front:	10.88
	Ground Clearance (in), Rear:	10.88
	Ground to Top of Frame (in):	- TBD -
	Ground to Top of Load Floor (in):	- TBD -
	Height, Overall (in):	78.35
	Length, Overall (in):	231.7
	Overhang (in), Front:	- TBD -
	Overhang (in), Rear w/o bumper:	- TBD -
	Wheelbase (in):	147.53
	Width, Max w/o mirrors (in):	81.24
INTERIOR DIMENSIONS	Front seat Head Room (in):	43.03
	Front seat Hip Room (in):	61.18
	Front seat Leg Room (in):	44.53
	Front seat Shoulder Room (in):	66.02
	Passenger Capacity:	6
	Second seat head room (in):	40.12
	Second seat hip room (in):	60.24
	Second seat leg room (in):	43.4
	Second seat shoulder room (in):	65.16

AutoDiary

Used 2021 Chevrolet Silverado 1500 4WD Crew Cab 147" Custom Trail Boss (#AV270003)

Technical Specifications (continued)

Payload/Trailering Specifications

TRAILERING	Dead Weight Hitch (lb):	5000
	Dead Weight Hitch-Max. Tongue Load:	500
	Fifth Wheel Hitch (lb):	7200
	Fifth wheel hitch-Max. Tongue Load:	1800
	Wt Distributing Hitch (lb):	7300
	Wt. Distributing Hitch-Max. Tongue Load:	730
WEIGHT INFORMATION	Curb Weight (lb):	2839
	Gross Axle Wt Rating (lb):	3800
	Gross Combined Wt Rating (lb):	12800
	Gross Vehicle Wt Rating (lb):	6900
	Rear Curb Weight (lb):	1976
	Rear Gross Axle Weight Rating (lb):	3800

Powertrain - Advanced Specifications

COOLING SYSTEM	Engine Oil Cooler:	- TBD -
DIFFERENTIAL	Front Axel Ratio (:1):	3.42
	Rear axle ratio (:1):	3.42
ELECTRICAL	1st battery Cold Cranking Amps @ 0° F:	730
TRANSFER CASE	Gear Ratio (:1), High:	1.00
	Gear Ratio (:1), Low:	2.69
	Transfer Case Model:	Magna MP3023/4

AutoDiary

Used 2021 Chevrolet Silverado 1500 4WD Crew Cab 147" Custom Trail Boss (#AV270003)

Technical Specifications (continued)

Powertrain - Basic Specifications

ENGINE	Displacement:	4.3L/262
	Engine Order Code:	LV3
	Engine Type:	Gas V6
	Fuel System:	Direct Injection
	SAE Net Horsepower:	285 @ 5300
	SAE Net Torque (lb ft):	305 @ 3900
FUEL ECONOMY	City EPA Fuel Economy Est (MPG):	14
	Fuel Economy Est-Combined (MPG):	16
	Hwy EPA Fuel Economy Estimate (MPG):	18

Dealer Map

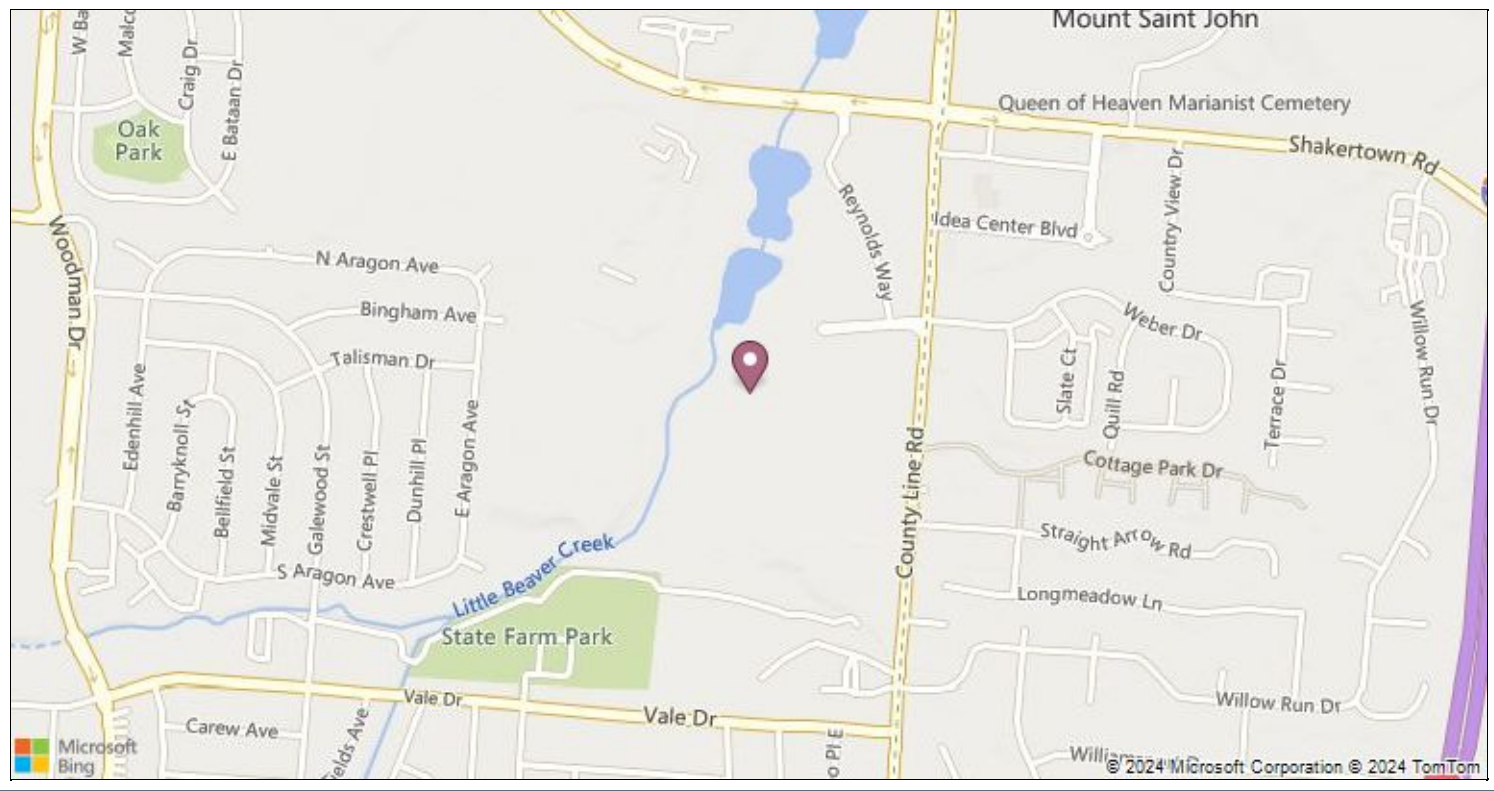

Prepared 5/8/2024

Page 11 of 12



Reynolds Motors
One Reynolds Way
Dayton, OH 45430

Bill McCarty
William_McCarty@ReyRey.com
(800) 767-0080
(888) 490-1571
www.nakedlimomotors.com

AutoDiary

Used 2021 Chevrolet Silverado 1500 4WD Crew Cab 147" Custom Trail Boss (#AV270003)

Recommended Vehicles

Recommended Vehicle #1



2020 Chevrolet Silverado 1500 4WD Crew Cab 147" RST

Business Unit:	Reynolds Motors
Stock #:	PP336684
Stock Type:	Used
Mileage:	41544
Exterior Color:	Red Hot
Price:	\$37,420.00

Recommended Vehicles

Recommended Vehicle #2

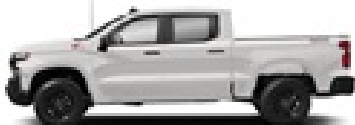

2020 Chevrolet Silverado 1500 4WD Crew Cab 147" LT Trail Boss

Business Unit:	Reynolds Motors
Stock #:	PP237670
Stock Type:	Used
Mileage:	92223
Exterior Color:	Summit White
Price:	\$35,600.00

Recommended Vehicles

Recommended Vehicle #3



2024 Chevrolet Silverado 1500 2WD Reg Cab 140" Work Truck

Business Unit:	Reynolds Motors
Stock #:	NA270416
Stock Type:	New
Mileage:	41
Exterior Color:	Summit White
Price:	\$37,035.00

Prepared 5/8/2024

Page 12 of 12



Reynolds Motors
One Reynolds Way
Dayton, OH 45430

Bill McCarty
William_McCarty@ReyRey.com
(800) 767-0080
(888) 490-1571
www.nakedlimemotors.com